



94 Sherborne Road Chichester PO19 3AL

'A superb house close to the city centre with large garden'



2



3



1

EPC D

- Three bedrooms semi-detached house
- Opposite small parade of shops
- Large rear garden
- Modern kitchen/dining room
- Less than one mile from city centre
- Cloakroom & brand new A* rated gas boiler
- Good size garage
- 'Morso' wood burning stove in sitting room

A superb 1950s semi-detached house opposite a small parade of shops, and within walking distance to the north/west of the city centre.

The property is very well presented throughout with a modern kitchen/dining room, cloakroom and utility/boot room, three first floor bedrooms and a modern shower room. The windows are double glazed and the heating is gas fired to radiators.

The large east facing rear garden has an area of kitchen garden as well as areas of lawn and a delightful paved terrace. which leads from the kitchen/dining area, and from the boot/utility room - which also has an internal door to the garage.





Sherborne Road, Chichester, PO19

Approximate Gross Internal Area = 87.6 sq m / 943 sq ft

Garage = 16.6 sq m / 179 sq ft

Total = 104.2 sq m / 1122 sq ft

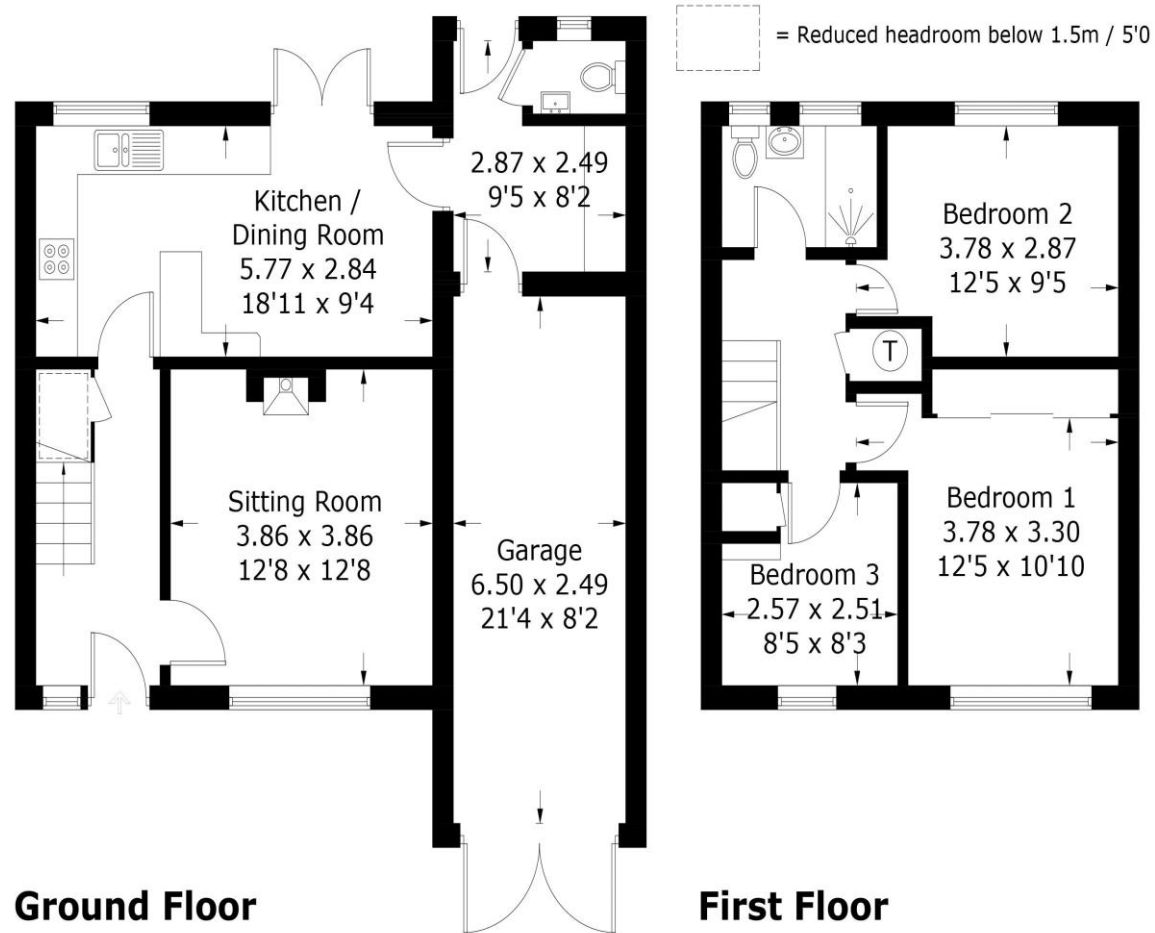

These plans are for representation purposes only as defined by RICS - Code of Measuring Practice. Not to Scale. (ID502707)

K340 Printed by Ravensworth 01670 713330



56 West Street, Chichester, West Sussex, PO19 1RR
 01243 216888
hello@kentonbudd.com

Kenton Budd Estate Agents wish to advise prospective purchasers that we have not checked the services or appliances. The sales particulars have been prepared as a guide only; any floor-plan or map is for illustrative purposes only. Kenton Budd Estate Agents, for themselves and for the vendors or lessors of this property whose agents they are give notice that: the particulars have been produced in good faith; do not constitute any part of a contract; no person in the employment of Kenton Budd Estate Agents has any authority to make or give any representation of warranty in relation to this property.